

Taylor-Taylor Fairforest Section
Union County, South Carolina, AC +/-

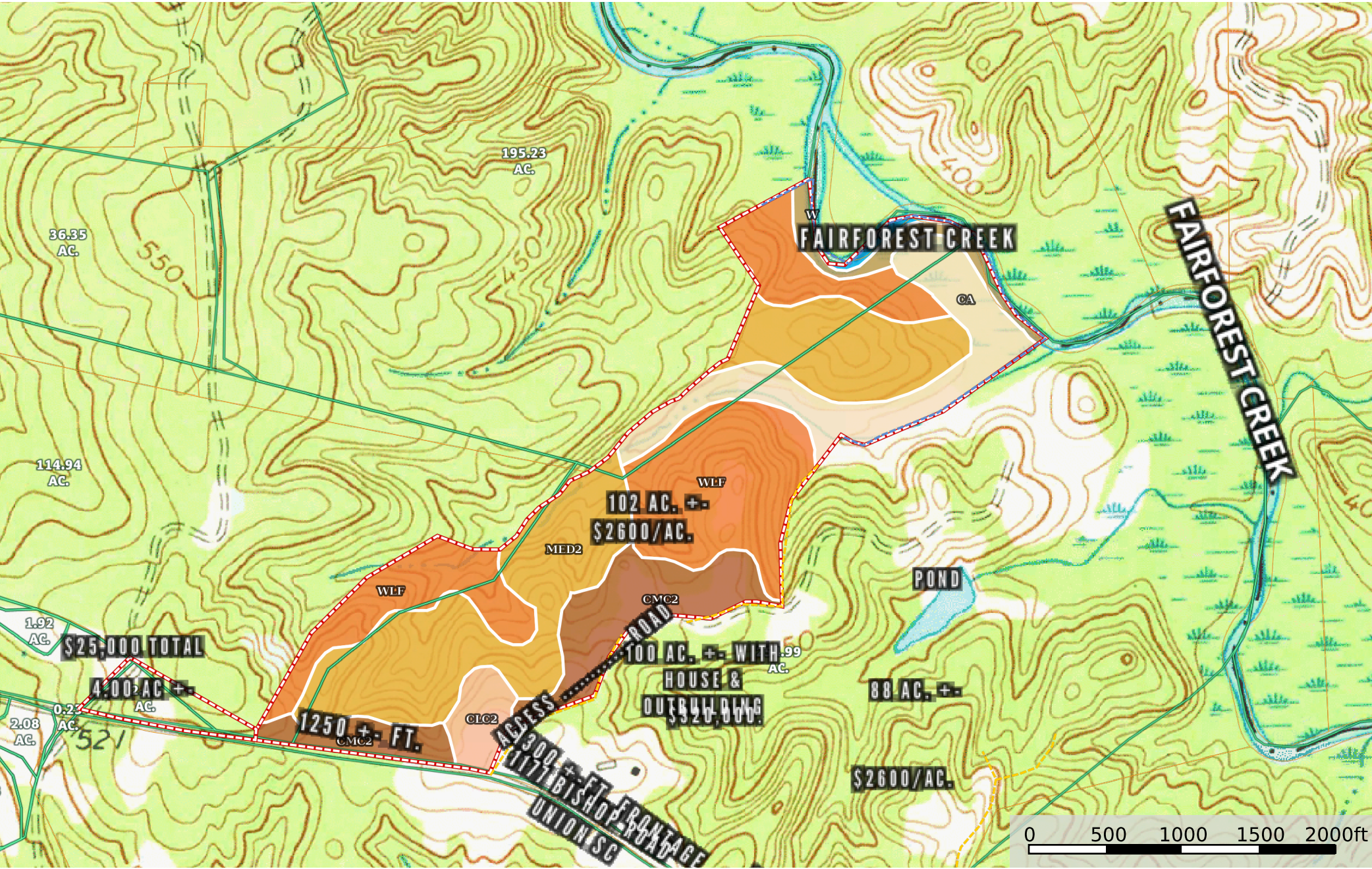

Boundary Road / Trail Stream

|  Boundary 102.1 ac









SOIL CODE	SOIL DESCRIPTION	ACRES	%	CAP
Wc	Wehadkee-Chewacla complex	3.4	3.31	4w
WIF	Wilkes soils, 15 to 40 percent slopes	32.4	31.75	7e
Ca	Cartecay-Toccoa complex	13.9	13.64	3w
MeD2	Madison sandy clay loam, 10 to 15 percent slopes, eroded	33.9	33.21	6e
CmC2	Cecil sandy clay loam, 6 to 10 percent slopes, moderately eroded	14.2	13.93	4e
W	Water	0.8	0.79	-
CIC2	Cecil sandy loam, 6 to 10 percent slopes, moderately eroded	3.4	3.37	3e
TOTALS		102.1	100%	5.41

Capability Legend

Increased Limitations and Hazards

Decreased Adaptability and Freedom of Choice Users

Land, Capability

								
	1	2	3	4	5	6	7	8
'Wild Life'	•	•	•	•	•	•	•	•
Forestry	•	•	•	•	•	•	•	
Limited	•	•	•	•	•	•	•	
Moderate	•	•	•	•	•	•		
Intense	•	•	•	•	•			
Limited	•	•	•	•				
Moderate	•	•	•					
Intense	•	•						
Very Intense	•							

Grazing Cultivation

(c) climatic limitations (e) susceptibility to erosion

(s) soil limitations within the rooting zone (w) excess of water